



The Leung Property

53 Lake Drive, Fairy Lake

Planting plan created by The District Municipality of Muskoka

Survey Date: 08/13/2020



Schedule A:

Plants & Property

Land Characteristics

This planting plan is designed based on the land characteristics identified during the day of the site visit. Plants are chosen according to the soil and light conditions on your property. The number of plants chosen for each planting compartment takes into account the square metre area of the space, as well as the amount of current vegetation cover. **Your property is part of ecoZone: 4b**

Land Characteristics by Compartment

	Length	Width	Area	pH	Soil	Moisture	Light	Height
A	10.2m	1.5m	15.3m ²	acidic	loamy, clay	normal, moist	full sun, partial sun	any
B	4.2m	6.7m	28.1m ²	acidic	loamy, clay	normal, moist	partial sun	any
C	3m	16.2m	48.6m ²	acidic	sandy, loamy	normal	full sun, partial sun	any
D	8.6m	7m	30.1m ²	acidic	sandy, loamy	normal	full sun, partial sun	any
E	5.9m	2m	11.8m ²	acidic	loamy	normal	full sun, partial sun	any
F	0.5m	5.4m	2.7m ²	acidic	loamy	normal	full sun, partial sun	max 1.5m
G	5.5m	5.5m	30.2m ²	acidic	sandy, loamy	normal	full sun	any
	37.9m	6.33m	166.8m ²					

Plant Selection Summary

The following shrubs and trees are chosen for their suitability and survivability given the current soil and light conditions in each compartment on your property, as well as preferable features.

Plant Species	A	B	C	D	E	F	G	Potted	Bareroot	Wildflower
Tamarack	1							1		
Narrow Leaved Meadowsweet	6	3		3				12		
Steeplebush	3							3		
Silky Dogwood	1	1	2					4		
Red Osier Dogwood	1	2	2	1			3	9		
Sweet Fern	5							5		
Pussy Willow	1							1		
White Birch	1		1				1	3		
Gray Dogwood	1		2					3		
Spotted Joe-Pye Weed	3									3
Blue Vervain	3									3
Royal Fern	4									4
White Pine		1	1					2		
Winterberry Holly		5						5		
Snowberry		3					9	12		
Ostrich Fern		12								12
Ninebark			3					3		
White Spruce			2					2		
Eastern Hemlock			1					1		
Fragrant Sumac			6		3			9		

New England Aster	5							5		
Black Chokeberry			2	1				3		
Red Maple	1							1		
Wild Bergamot			3							3
Black-Eyed Susan	3							3		
Purple Coneflower			3							3
Smooth Aster	6			9				15		
Smooth Wild Rose				3				3		
Shrubby St. John's wort	3							3		
Big bluestem or Turkey foot				3						3
Lowbush Blueberry	5							5		
Subtotal	30	27	25	22	13	5	22	90	0	54
Totals	144									

Plant Information

The following table summarizes key information about each plant selected for your property.



Tamarack

Height: 20 m

Tamarack is a small to medium sized, deciduous coniferous tree species that grows up to 20 m tall. This plant may also be known by the common name American Larch. The bark is scaly and reddish brown coloured. The needles are delicate, 2-4 cm long, blueish-green coloured, grow in clusters of 15 to 25, and change golden yellow in the fall. This tree provides food and habitat for wildlife species, including birds and mammals. Tamarack is a fast-growing, long lived species that can live up to 150 years and is found across all of Canada. The wood from this tree is decay-resistant and has been used to make railway ties, posts, and crates. Tamarack is considered unique because it is the only conifer species to drop its needles in the fall.



Narrow Leaved Meadowsweet

Height: 1-2m

The Narrow Leaved Meadowsweet is an erect, deciduous shrub, which grows in the shape of a mound to a height of 1-2m. This species develops numerous branches and branchlets, giving it a sparse appearance. Leaves produced are simple and narrow with sharply toothed borders growing alternately along the branches. These bright, light green leaves appear crowded, as they grow close together on the stocks and branches. During the fall, leaves turn a yellow-red or yellow-orange colour. Small white to light pink flower clusters appear in the spring growing in a dense, narrow pyramid at the terminal ends of the branches. During late summer to early fall, these flowers produce smooth, papery seed pods.



Steeplebush

Height: 1 m

The Steeplebush is a deciduous shrub species that typically grows about 1 m in height. This plant may also be known by the common names: Rose Spiraea or Hardhack. The leaves are dark green, about 7 cm long, elliptic to ovate shaped, have toothed margins, and have dense yellowish brown hairs on the undersides. The flowers are tiny, rose pink to purplish coloured, bloom in late summer, and appear on tall, dense, steeple shaped clusters. This plant is useful for controlling erosion and stabilizing shorelines. The flowers are also beneficial for pollinator species, like bees and butterflies.



Silky Dogwood

Height: 2-4m

The Silky Dogwood is a large, deciduous shrub species native to Eastern North America that reaches a height of 2-4m. This species produces a rounded shape due to its numerous upright branches stemming from a central, multi-stemmed base. Branches which grow touching the ground can develop their own root system, often creating thickets. During the spring and summer, branches are a shiny, light green colour and change to a red colour during the fall and winter. This species produces simple, lance-shaped leaves arranged oppositely along the branches. During the spring and summer, the foliage is a deep green colour and turns dark red-purple during the fall prior to dropping. Small, yellow-white flowers bloom during mid-June, maturing into bright blue berries in September. This species of Dogwood grows best alongside Willow when being planted to mitigate erosion and stabilize shorelines.



Red Osier Dogwood

Height: 1.5-4m

The Red Osier Dogwood is a medium-sized, deciduous shrub native throughout Northern and Western North America which typically grows to 1.5-4m. This species is multi-stemmed with numerous erect and ascending bright red branches that create a loose and spreading form. Leaves produced are simple, two-toned with a dark green upper side and light green underside. They are arranged opposite each other along the branches. During the fall, the foliage turns a brilliant red to dark purple. Clusters of small, creamy white flowers form on the terminal ends of the branches between June and July. The Red Osier Dogwood produces blueish-white fruiting bodies during late summer, which may persist throughout the winter. This shrub's berries provide an important winter food source for numerous species, from large deer to small wintering birds.



Sweet Fern

Height: 1 m

Sweet Fern is a deciduous shrub species that typically grows 1 m in height. The leaves are dark green coloured, alternately arranged, narrow, lance shaped, have entire margins, rounded lobes, and are deeply notched, giving the appearance of a fern. The leaves are also aromatic when rubbed or crushed. The flowers are small, yellowish green catkins, which bloom between May and June. The fruits are greenish brown, burr like nutlets. This plant fixes its own nitrogen, which allows it to grow in poor soil and benefit nearby plants. This plant spreads well to produce small colonies. It is useful for controlling erosion and stabilizing shorelines.



Pussy Willow

Height: 6m

The Pussy Willow is a fast growing, deciduous shrub or small tree found reaching heights of 6m, and is from British Columbia to Newfoundland. This species grows from shoots extending from the base of the trunk, creating a multi-stemmed, tall, round bush. The Pussy Willow is an ideal species for bank stabilization and erosion control due to its large, fibrous root system and love of water. This species branches extend from the main shoots and are usually hairy and reddish-brown in colour. The main shoots of Pussy Willow are smooth and greyish-brown, becoming scaly with age. It produces simple, narrow, lance-shaped leaves alternately arranged along the branch. The Pussy Willow yields purple-brown fuzzy catkins which will form long-beaked and finely haired capsules during May and June.



White Birch

Height: 15-25m

The Paper Birch is a medium-sized (15-25m), deciduous tree which may also be referred to as White Birch or Canoe Birch. This species produces a sparse, irregular crown which arises from a slender trunk. This tree is best known for distinctive white, horizontally flaking bark, from which its name is derived. The Paper Birch produces light green, egg-shaped, 5-10 cm long leaves alternately arranged. During the fall, the light green foliage turns a bright yellow colour. During the spring, catkins appear and produce winged seed keys which mature and drop between the fall and following spring.



Gray Dogwood

Height: 2-3m

The Gray Dogwood, also referred to as Northern Swamp Dogwood or Panicle Dogwood, is a medium-sized, deciduous shrub which typically grows 2-3m. This species is multi-stemmed, with a full, round form. The leaves are green and arranged alternately along the branches. During the fall, leaves turn a bright red to deep purple colour. Between May and June, showy clusters of small white flowers bloom. These flowers turn into white fleshy berries late in the summer. The reddish-pink stems hold the berries throughout the winter, creating an artful contrast to the gray bark and snowy scenery. The Gray Dogwood is tolerant of a variety of environmental conditions and its complex, fibrous root system make it an ideal plant to use for controlling erosion.



Spotted Joe-Pye Weed

Height: 1.5 m

Spotted Joe-Pye Weed is a colourful wildflower species that can grow up to 1.5 m tall and can spread about 1 m. It has a plain or spotted purple stem, which is sometimes covered in fine hairs. The leaves are large, lanceolate shaped, have serrated edges, and appear in whorls of 3-5. The flowers are showy, fragrant, bright pink/purple coloured, have 8-20 disk florets, appear in clusters at the top of a flowering stem, and bloom in mid to late summer. The flowers are beneficial to pollinator species, like bees and butterflies. This plant spreads well and can form small colonies. The roots can be useful for controlling erosion and stabilizing shorelines.



Blue Vervain

Height: 1.5 m

Blue Vervain is a perennial wildflower species that grows about 1.5 m in height. It has a slender, upright form with reddish-green coloured, rough-haired stems. Its leaves are oppositely arranged, lance-shaped, and on short petioles with large serrations along the edge. Occasionally, there are two lobes present at the base of the leaves. The flowers are showy, blueish purple coloured, have five petals, appear on dense spikes at the top of flowering stems, and bloom between July and September. The flowers bloom first at the bottom of the spike, travelling upwards and blooming in bands. This plant spreads well and can form small colonies. The flowers are beneficial to pollinator species, like bees and butterflies. The seeds are also beneficial to wildlife species, like birds and small mammals.



Royal Fern

Height: 1 m

Royal Fern is a perennial fern species that typically grows less than 1 m in height. This plant may also be known by the common name Flowering Fern. Fiddleheads appear from the base of the plant and unfurl into green, arching, pinnately compound leaves. The leaves of this fern are well separated, broader, and more rounded than other ferns, giving it the appearance of a pea plant. Erect, spore-bearing fronds grow out of the center of the leaves in the early spring and turn brown in the fall. The fronds of this fern have a flower like appearance.



White Pine

Height: 30m

The White Pine is Ontario's provincial tree. This species is the largest northeastern conifer with soft and light needles, which typically grows 30m in height. The needles are bundled into groups of 5 and are spirally spread around the twigs. White Pine bark is smooth and grey-green when young, becoming dark grey and deeply furrowed upon maturation. This tree produces yellow-green seed cones which are long, cylindrical, and covered in 50-80 scales. Unfortunately, this species is susceptible to White Pine Blister Rust and attacks by the White Pine Weevil. White Pine is a hardy tree which can tolerate a wide range of soil conditions, from sphagnum bogs to dry sandy and rocky ridges.



Winterberry Holly

Height: 3 m

Winterberry is a deciduous shrub species that typically grows about 3 m in height. The leaves are dark green coloured, alternately arranged, and have toothed margins. The flowers are small, greenish white coloured, not showy, and bloom between June and July. The fruits are attractive, bright red berries, which are not edible, only grow on female plants nearby male plants, and persist throughout the winter, hence the name. This plant spreads well and can form small colonies. The roots can be useful for controlling erosion and stabilizing shorelines. The berries are highly beneficial to wildlife species, like birds and small mammals, throughout the winter.



Snowberry

Height: 1-2m

The Snowberry is a small shrub known for its white berries bunching at the nodes. This species produces oval-shaped, oppositely arranged, dark green colored leaves with smooth margins on short stalks. The shrub grows 1-2m in height. This shrub yields white to pink clusters of bell-shaped flowers during the summer. The fruiting bodies produced by this shrub are small, white berries that grow in bunches. These berries provide a good food source to a variety of animals, but are poisonous to humans. Snowberry is an ideal species for bank stabilization applications because its roots are vigorous and deep ranging. .



Ostrich Fern

Height: 1.5 m

The Ostrich Fern is a coarse, erect to arching perennial fern, that can grow up to 1.5 m in height. The stems are clustered and arching while the leaves are ostrich-plume shaped, widest near top, and very gradually narrowed to the base. The size of the leaves grow up to 1.5 m long and 12-40 cm wide, with around 40 pairs of leaflets or pinnae. The leaflets are long, narrow-pointed, and ascending. The leaves are fertile, with spore clusters on the undersides of sub-leaflets.



Ninebark

Height: 2-3m

The Common Ninebark is a very hardy, large (2-3m in height), deciduous shrub naturally occurring within riparian zones. This species is often planted as an ornamental shrub for its exfoliating bark which reveals reddish-light brown inner bark. This shrub is multi-stemmed with numerous horizontal and ascending branches creating a full, round shape. The Common Ninebark produces dull green, ovate to round shaped leaves with three to five lobes per leaf. During the fall the leaves turn brilliant yellow or dark purple. Between May and June, showy, bell-shaped flowers bloom in clusters on the terminal ends of the branches. During the summer, these flowers give way to small green or green-yellow berries which turn a bright red upon ripening.



White Spruce

Height: 20m

The White Spruce is a hardy, coniferous tree species that grows up to 20 m in height. This species has a relatively uniform form with bark that is loose, scaly, and grayish brown. The needles are about 2 cm long and blueish green in color. The cones are 5-7 cm long, cigar-shaped, and have smooth margin scales. The bark of White Spruce is smooth and light grey when young, turning dark grey and scaly upon maturation. This tree is important for providing food and shelter to wildlife species including deer, porcupines, birds, and small rodents. White spruce is a long lived tree species, and usually lives 250-350 years old. However, individuals have been seen that have lived up to 1000 years old.



Eastern Hemlock

Height: 30m

The Eastern Hemlock, or Canadian Hemlock, is a medium-large sized conifer tree reaching 30m in height, which has a conical shape and a tapered trunk. This species produces slender branches that grow horizontally from the trunk with heavy foliage and a drooping terminal end. The Eastern Hemlock produces flat needles that are two-ranked, with shorter needles on the upper side of the branch. This species produces small, oval-shaped cones approximately 2 cm long, which are initially green in colour and turn brown in the fall. The Eastern Hemlock is known to have the smallest needles and cones of its genus. This species has shallow and wide spreading roots, which make it an ideal tree species to plant for controlling erosion on dry slopes.



Fragrant Sumac

Height: 1-2m

The Fragrant Sumac is a medium-sized deciduous shrub within the Cashew family. This species grows between 1-2 meters in height, is multi-stemmed, and produces a round, dense crown composed of erect and spreading branches. Between March and April, small yellow flower clusters bloom on the terminal ends of the branches prior to leaf development. Fruit development begins during late summer. Small, red, hairy berries are produced and can remain on the plant throughout the winter. Male catkins develop on the plant in September. Fragrant Sumac leaves are simple and arranged alternately along the branch. Leaves produced are simple and trifoliate with a large center lobe, appearing similar to Poison Ivy. During the spring and summer, the leaves are light green to green-yellow in colour turning a bright yellow to red or dark purple in autumn. Crushed leaves and stems of the Fragrant Sumac produce a fragrant citrus aroma, hence the common name. The aroma of this shrub is attractive to butterfly species, making it the perfect addition to any butterfly garden. The roots of the Fragrant Sumac are shallow, fibrous, and spread rapidly, making it an ideal choice for stabilizing shorelines and mitigating erosion on steep slopes. Unlike other Sumac species, Fragrant Sumac is significantly less aggressive and easily maintained.



New England Aster

Height: 2m

New England Aster is a showy perennial wildflower with an average height of about 120 cm but can grow up to 2 m tall. It has a central stem with branching in the upper half covered in fine white hairs. Its leaves clasp these stems as they have no petioles. The basal leaves are spatula-shaped, while the stem leaves are alternate and lance-shaped. The leaves are also covered in soft white hairs. Its showy flowers are clustered at the ends of the central stem and surrounding branches. Each flower is composed of 30+ deep purple ray florets surrounding numerous golden disk florets. These plants excel in moist soils with lots of sun. It is often found along lake shorelines, forest edges, in wet meadows, or in marshes/swamps. New England Aster reproduces and spreads using both achenes, which are dispersed by wind and a rhizomatous root system, allowing this plant to colonize open areas. It is also known to easily colonize recently disturbed areas so could be considered for difficult sites that are hard to grow on. This wildflower species attracts lots of pollinators such as bees and butterflies but rarely attracts wildlife, such as wild turkey, deer, and rabbit.



Black Chokeberry

Height: 1-3m

The Black Chokeberry is a medium sized deciduous shrub that typically grows between 1-3m with edible fruit. This species requires full sun to partial shade and can tolerate soil conditions from loamy and moist to rocky and dry. Naturally, Black Chokeberry is found in wet wooded areas such as; swamps, along shorelines, and within forest understory. This species is multi-stemmed, and forms thickets from stems which arise from the roots. Leaves are simple, growing alternately along the branch turning a bold red to orange during the fall. During spring, clusters of showy, white flowers appear turning into dark purple berries by fall. This species is resistant to drought, insects, pollution, and disease. The Black Chokeberry is often cultivated as an ornamental plant and food product. Additionally, this species is useful for bank stabilization and erosion control applications.



Red Maple

Height: 12-25m

The Red Maple is the most common and widespread deciduous tree of Eastern and Central North America. This species can grow 12-25m at maturity. The trunk of this hardwood species is branch free from the base to about halfway up the trunk. When planted in an open area, the trunk can divide and branch out fairly close to the ground. As the tree matures, it develops a short, narrow crown consisting of horizontal and ascending branches. The leaves on the Red Maple grow opposite each other on the branches. During the summer, leaves are bright green on top with a whitish underside. During the fall, the leaves turn a bright red or scarlet colour, from which the name is derived. Prior to leaf development, tree flowers bloom in early May. Red Maple tree flowers are small and red to yellowish orange in colour, growing in clusters on a thin stalk. During June and July, tree flowers develop into reddish winged keys, which hold and disperse seeds. The Red Maple plays an important role in the lumber industry, as its wood is excellent for woodworking.



Wild Bergamot

Height: 1 m

Wild Bergamot is a perennial wildflower species that is member of the mint family and can grow about 1 m tall. Its stems are light green and smooth with abundant branching on the upper half. The leaves are oppositely arranged, broadly lanceolate shaped, 6-10 cm long, and have toothed edges. The also leaves emit a aromatic minty/oregano scent when crushed. The flowers are showy, pink/lavender coloured, appear on the ends of flowering stems, and bloom between July and September. The flowers bloom in the center of the head first, moving outwards creating a wreath. The flowers are beneficial to pollinator species, like bees and butterflies. This wildflower spreads well and can be used to naturalize un-vegetated areas. The roots can be useful for controlling erosion and stabilizing shorelines.



Black-Eyed Susan

Height: 1 m

Black-Eyed Susan is a popular biennial or a short-lived perennial wildflower species that typically grows about 1 m in height. Its leaves are green, alternately arranged, lance shaped, and covered with bristly hairs giving the leaf a grey/green colour. The flowers are daisy-like, have 8-20 yellow ray florets surrounding numerous dark brown disk florets, and blooms between June and September. The flowers are beneficial to pollinator species, like bees and butterflies. The seeds are also beneficial to wildlife species, like birds and small mammals. This flower blooms for long periods.



Purple Coneflower

Height: 1m

Purple Coneflower is a perennial wildflower that typically grows about 1 m tall. This plant may also be known by the common name Echinacea. The leaves are dark green coloured, alternately arranged, lance shaped with pointed tips, and have serrated margins. The flowers are showy, pale purple to pink, have 15-20 toothed petals, appear atop erect stems, and bloom between June and August. This wildflower spreads well and can be used to naturalize un-vegetated areas. The roots can be useful for controlling erosion and stabilizing shorelines. This flower blooms for long periods. The flowers are beneficial to pollinator species, like bees and butterflies. The seeds are also beneficial to wildlife species, like birds and small mammals.



Smooth Aster

Height: 1 m

The Smooth Aster is a perennial wildflower species that typically grows about 1 m in height. The stems are tough and have multiple erect branches. The leaves are alternately arranged, smooth, waxy, and have entire margins. The flowers are lavender blue coloured, have yellow centers, appear on flowering stems, and bloom from August to October. The flowers are attractive to pollinator species like bees, hummingbirds, and butterflies.



Smooth Wild Rose

Height: 1.5m

The Smooth Wild Rose is a shrub species that grows about 1.5 m tall. The name is derived from the fact that it is almost thornless with only a few sharp thorns present near its base. This native shrub is best known for producing beautiful pale pink flowers with five saucer-like petals surrounding a yellow center. The Smooth Wild Rose produces bright red rose hip fruiting bodies which develop during the summer and persist throughout the winter. Leaves produced are alternate and compound, consisting of 5-7 serrated, egg-shaped leaflets.



Shrubby St. John's wort

Height: 1 m

The Shrubby St. John's Wort is a small 1m tall, round, deciduous shrub which grows stiff, erect branches with red to purple bark. Leaves produced are blue-green, simple, elliptical-shaped, 3-7 cm long and oppositely arranged along the branch. During the fall, the leaves turn a deep red colour. This species yields large bright yellow flowers which grow in clusters of at the terminal end of branches during late June to August. By September, the flowers become brown seed pods and release small black seeds throughout October. Shrubby St. John's Wort produces fibrous, spreading roots, making it an ideal species for bank stabilization applications.



Big bluestem or Turkey foot

Height: 2 m

Big Bluestem is a perennial, ornamental grass species that typically grows less than 2 m in height. This plant may also be known by the common name Turkey foot. The leaves are gray to bluish green in the spring, have reddish tinges in the summer, and change bronzy lavender in the fall. The flowers are purplish, three pronged resembling a turkey foot, appear in finger like clusters on tall stems, and bloom between September and February. Big Bluestem is easy to grow and is low maintenance. This plant spreads well and can form small colonies. The roots can be useful for controlling erosion and stabilizing shorelines. The seeds are also beneficial to wildlife species, like birds and small mammals.



Lowbush Blueberry

Height: 60 cm

The Lowbush Blueberry is a low growing, deciduous shrub that only reaches about 60 cm in height. This species grows erect, with many spreading and ascending branches. New branch growth is soft and green-brown in colour, while older branches are woody and have shredded looking bark. The leaves are small, simple leaves alternately arranged, and have finely serrated margins. During the fall, this shrub's lustrous blue-green leaves turn into an electrifying bronze, scarlet or crimson colour. Clusters of small, white, bell-shaped flowers bloom between May and June. By July, the flowers give way to clusters of edible blueberries. These berries provide a significant food source for a variety of bird and mammal species.

Compartment A

Naturalization Area

Deer issues

- ⚖️ PH: acidic
- 🌱 DEPTH: potted
- 💧 MOISTURE: normal, moist
- 🌀 SOIL TYPE: loamy, clay
- 📏 PLANT HEIGHT: any
- ☀️ LIGHT CONDITIONS: full sun, partial sun



Tamarack

1



Steeplebush

3



Red Osier Dogwood

1



Narrow Leaved Meadowsweet

6



Silky Dogwood

1



Sweet Fern

5



Pussy Willow

1



White Birch

1



Gray Dogwood

1



Spotted Joe-Pye Weed

3



Blue Vervain

3



Royal Fern

4

Compartment B

Naturalization Area

Deer issues

- ⚖ PH: acidic
- 🌱 DEPTH: potted
- 💧 MOISTURE: normal, moist
- 🌱 SOIL TYPE: loamy, clay
- 📏 PLANT HEIGHT: any
- ☀️ LIGHT CONDITIONS: partial sun



Narrow Leaved Meadowsweet

3



Red Osier Dogwood

2



Winterberry Holly

5



Silky Dogwood

1



White Pine

1



Snowberry

3



Ostrich Fern

12

Compartment C

Naturalization Area

Deer issues

- ⚖️ PH: acidic
- 🌱 DEPTH: potted
- 💧 MOISTURE: normal
- 🌾 SOIL TYPE: sandy, loamy
- 📏 PLANT HEIGHT: any
- ☀️ LIGHT CONDITIONS: full sun, partial sun

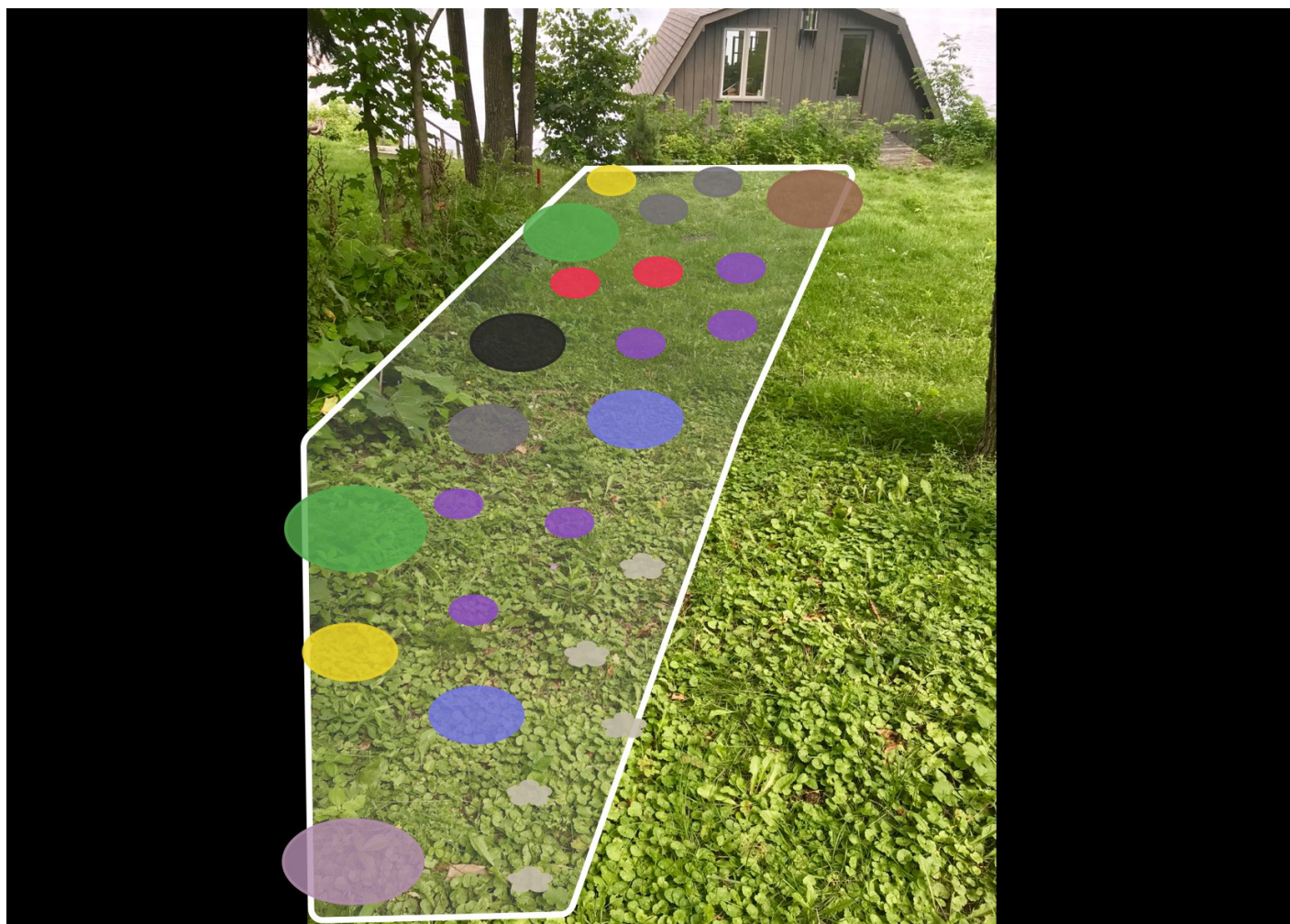

Silky Dogwood

2



White Birch

1



White Pine

1



Red Osier Dogwood

2



Gray Dogwood

2



Ninebark

3



White Spruce

2



Eastern Hemlock

1



Fragrant Sumac

6



New England Aster

5

Compartment D

Naturalization Area

Deer issues

- ⚖ PH: acidic
- 🌱 DEPTH: potted
- 💧 MOISTURE: normal
- 🌾 SOIL TYPE: sandy, loamy
- 📏 PLANT HEIGHT: any
- ☀️ LIGHT CONDITIONS: full sun, partial sun



Narrow Leaved Meadowsweet

3



Red Osier Dogwood

1



Black Chokeberry

2



Red Maple

1



Wild Bergamot

3



Black-Eyed Susan

3



Purple Coneflower

3



Smooth Aster

6

Compartment E

Naturalization Area

Deer issues

- ⚖️ PH: acidic
- 🌱 DEPTH: potted
- 💧 MOISTURE: normal
- 🌱 SOIL TYPE: loamy
- 📏 PLANT HEIGHT: any
- ☀️ LIGHT CONDITIONS: full sun, partial sun

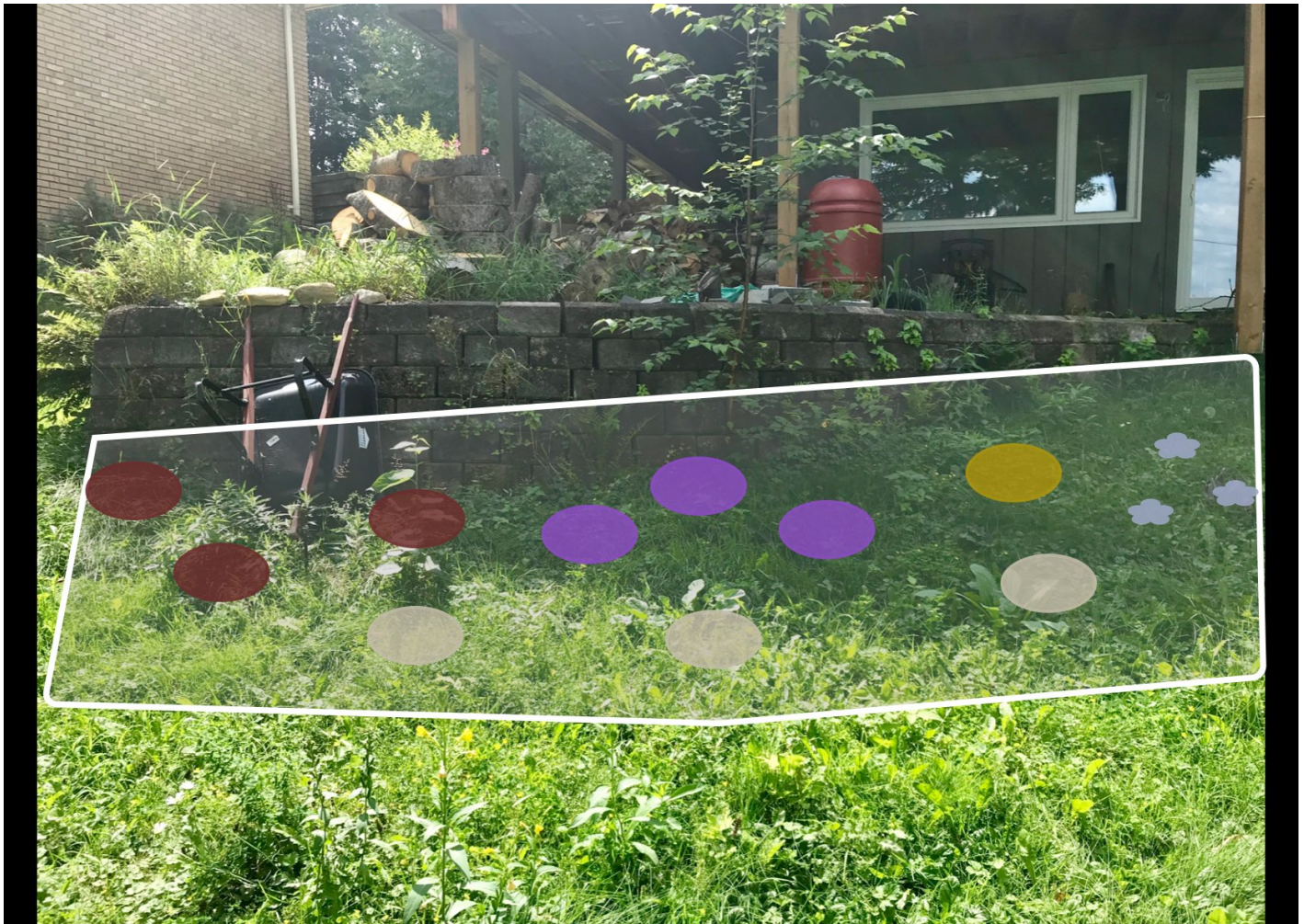

Fragrant Sumac

3



Black Chokeberry

1



Smooth Wild Rose

3



Shrubby St. John's wort

3



Big bluestem or Turkey foot

3

Compartment F

Naturalization Area

Deer issues

- ⚖️ PH: acidic
- 🌱 DEPTH: potted
- 💧 MOISTURE: normal
- 🌾 SOIL TYPE: loamy
- 📏 PLANT HEIGHT: max 1.5m
- ☀️ LIGHT CONDITIONS: full sun, partial sun



Lowbush Blueberry

5

Compartment G

Naturalization Area

Deer issues Road salt issues

- ⚖ PH: acidic
- 🌱 DEPTH: potted
- 💧 MOISTURE: normal
- 🌱 SOIL TYPE: sandy, loamy
- 📏 PLANT HEIGHT: any
- ☀️ LIGHT CONDITIONS: full sun

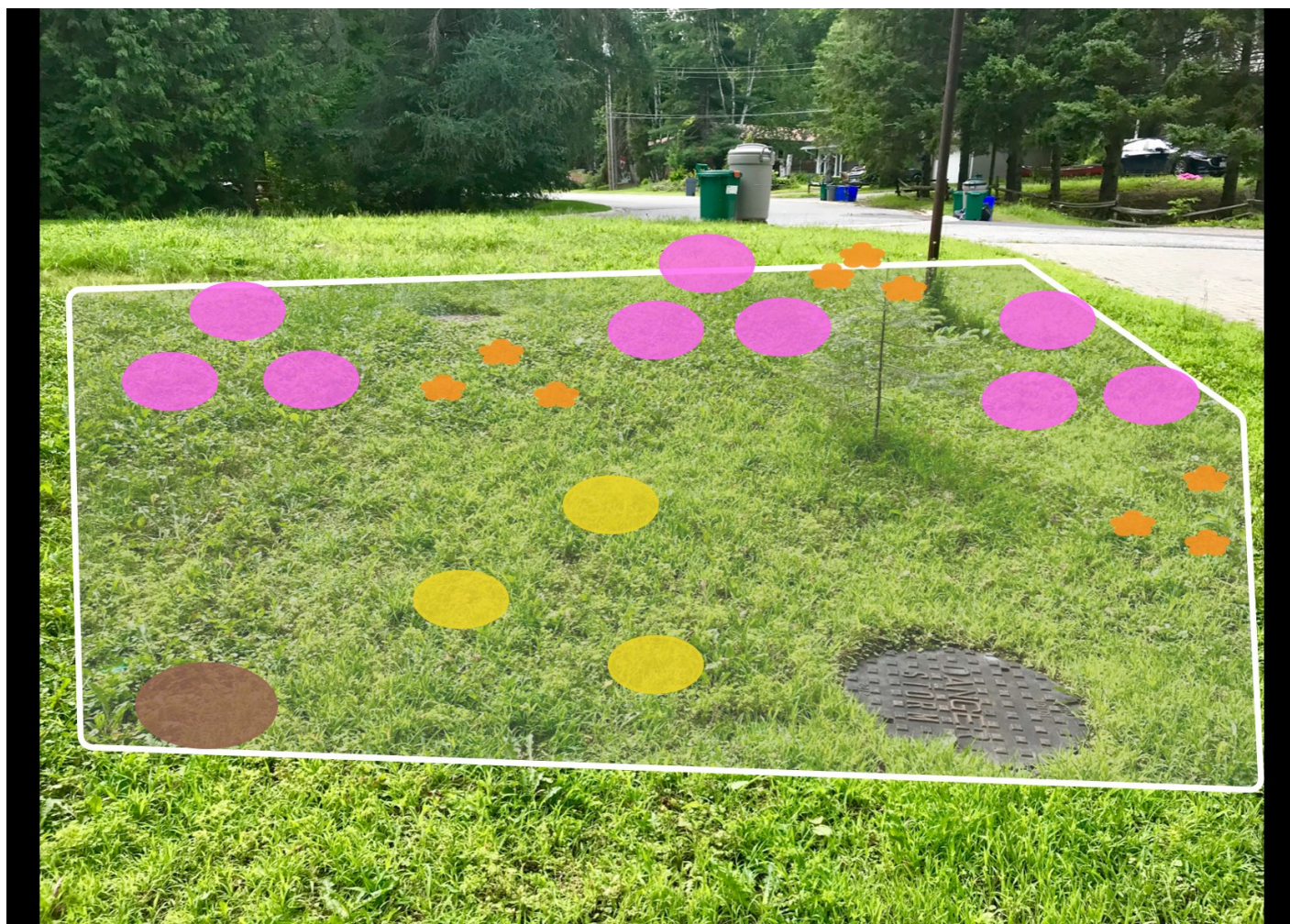

Red Osier Dogwood

3



White Birch

1



Snowberry

9



Smooth Aster

9



Schedule B

Financial Summary

Project by: The District Municipality of Muskoka

Shoreline Re-Naturalization Starter Kit includes: free site visit, customized re-naturalization planting plan for your shoreline property, native plants including free bare root (small) and potted (large) plants and wildflowers, coconut fibre pads to deter grass from growing around new plantings, tree guards for all deciduous trees, mulch for your wildflowers, Plant Care Guide with instructions on how to take care of your new plants, Habitat Creation Guide and a Wildflower Garden Guide.

Our planting plans are created onsite with you and provide detailed information and plans to re-naturalize your shoreline property. We take photos of areas for planting and overlay native plants that are well suited to your property based on site conditions such as soil type and sunlight availability.

We will work with you to create a plan that works for you including options for low growing plants in areas where views are important.

Item	Quantity	Cost/Item	Subtotal
Starter Kit fee			\$300
Free potted plants	20	\$0	\$0
Paid potted plants	70	12.00	840.00
Free bareroot plants	0	\$0	\$0
Free wildflowers	30	\$0	\$0
Paid wildflowers	24	6.00	144.00
Total costs			1284.00



Schedule C

Project Agreement

Stewardship Agreement

Please indicate your agreement to this proposed plan by signing the following Stewardship Agreement and submitting it, along with your financial contribution, to:

The District Municipality of Muskoka

70 Pine Street Bracebridge, Ontario P1L 1N3

Plant Availability

Please note that plant species may need to be changed based on plant stock availability at the time of ordering.

Project Completion

Upon receiving your signed stewardship agreement and financial contribution, a date will be booked for you to pick up your Natural Edge Kit. The District Municipality of Muskoka will supply all plants and materials. If you are paying for the planting to be completed for you, a date will be arranged for The District Municipality of Muskoka to plant your shoreline, bringing the plants and materials with them. If there are particular dates that you would prefer, we will do our best to accommodate your requests.

The Natural Edge Stewardship Agreement with The District Municipality of Muskoka

Agreement made this _____ Day of the Month of _____ in the Year _____.

BETWEEN Deborah Leung 53 Lake Drive Huntsville Ontario
(Hereinafter called the OWNERS)

AND **The District Municipality of Muskoka** 70 Pine Street
Bracebridge, Ontario P1L 1N3 (Hereinafter called DMM)

WHEREAS the Owners and DMM have met and discussed plans for shoreline naturalization on the specified area(s) in Schedule A existing on the Owners' land;

WHEREAS the Owners indicate approval of the project as proposed; and

WHEREAS the project is, or will be for the benefit of the Owners and others;

NOW THEREFORE THE PARTIES AGREE AS FOLLOWS:

1. This Agreement shall be in effect for a period of 5 years, commencing with the date of this Agreement.
2. The Owners and DMM agree that the areas where the work is to be performed is as described in Schedule A.
3. The Owners agree to pick up their Natural Edge Starter Kit from DMM's office and plant their shoreline within two days of receipt. The Owners will provide "after" photos of the work completed to be used for reporting purposes. If the Owners wish to have the planting completed for them, then DMM or its contractors, employees and agents will complete the planting at cost, as indicated in Schedule B.
4. If the planting is to be completed by DMM, then the Owners grant DMM, its contractors, employees and agents, the right to enter the property to perform the work agreed upon as outlined in Schedule A. In addition, DMM, its contractors, employees and agents may inspect the work performed for the purposes of monitoring the project and survival assessment, with prior agreement with Owners for date and time of inspection.
5. The Owners agree to contribute the "Landowner contribution" and pay the costs indicated in Schedule B.
6. In instances where the Owners are to pay DMM for work to be performed (outlined in Schedule A), the Owners agree to provide payments to DMM prior to the commencement of that operation. Failure of payment shall constitute a breach of this Agreement and the Owners agree that this Agreement will be terminated and thereupon the Owners agree to pay DMM the estimated costs of the operations of the project completed to date, if any.
7. The Owners agree, if necessary, to perform a reasonable amount of maintenance, which is described in the Native Plant Care Guide, available at naturaledge.watersheds.ca.
8. If a contractor is required to perform the work outlined in Schedule A, then the contractor carrying out the work on the land described will be required to take out and furnish evidence of a comprehensive policy of public liability and property damage coverage. The contractor and their workers will be required to be in good standing with the Workplace Safety and Insurance Board (WSIB) prior to performing the work.
9. The Owners agree not to remove, destroy or alter the project without prior consultation and approval of DMM. Pruning and trimming planted nursery stock, or adding replacement native nursery stock is exempt.
10. The Owners agree not to mow the planted area.
11. The Owners do acknowledge that DMM, its contractors, employees and agents, having performed said works, are not under further obligation with respect to survival of nursery stock, inspection, or maintenance.
12. The Owners, in the absence of negligence, hereby remise, release and forever discharge DMM, its contractors, employees and agents from all claims and demands for injuries, including death, loss, damages and costs in any way related to or connected with installation and maintenance of the work described or resulting from any deleterious effects of the work to the land or to the lands and buildings thereon retained by the Owners.

IN WITNESS WHEREOF the parties have agreed to the contents of this plan; SIGNED:

The District Municipality of Muskoka

Deborah Leung

Representative Signature:

Owner Signature:





About this program

About The District Municipality of Muskoka

The District of Muskoka is an upper-tier municipality that has monitored water quality in Muskoka area lakes since 1980. Since 2002, the Muskoka Water Strategy has provided integrated and strategic initiatives for the protection of Muskoka's water resources. The purpose of the strategy is to guide and minimize the impact of human activities on water resources; ensure human and environmental health; and preserve the quality of life in Muskoka.

This program was created by Watersheds Canada

We believe that every person has the right to access clean and healthy lakes and rivers in Canada. At Watersheds Canada, we work to keep these precious places naturally clean and healthy for people and wildlife to continue using for years to come. We love working with others to meet the needs of local communities, whether you're a concerned citizen, a landowner, a lake association looking for help, or a coalition of groups interested in activating your local community.